

# Champion®

The Dishwashing Machine Specialists

Project \_\_\_\_\_  
 Item No. \_\_\_\_\_  
 Quantity \_\_\_\_\_

UH330B UNDERCOUNTER

## STANDARD FEATURES

- **Heat Recovery/Condensate Removal with Dry Assist**
- **ENERGY STAR® Qualified**
- **Vari-Cycle** – multiple time cycles
- **“Shear Energy”** – a reduction in energy requirements while maximizing performance!
- **Cold water feed only.**
- **“Multi-Power”** – includes **“Multi-Volt”** and **“Multi-Phase”**. Allows for infield conversion to 208-240 volt and/or single to three phase with ease.
- **StemSure™** – Soft start to protect glasses and dishes from chipping and breaking.
- Insulated panels and booster with quiet double-wall construction.
- Rinse Sentry – extends the cycle time to ensure 180°F/82°C final rinse.
- Built-in electric booster for 180°F/82°C final rinse water.
- Pumped drain
- Low-water tank heat protection
- Detergent and rinse aid pumps
- Door safety switch
- Independent stainless steel interchangeable upper and lower wash and rinse arms
- Top mounted slide-out controls
- Stainless steel top and side panels
- 3-cycle time options for enhanced cleaning
- Automatic wash down cycle at end of day
- 1 Hp motor
- Advanced digital temperature monitoring
- Stainless steel construction



## UH330B

Undercounter High Temperature Dishwashing Machine with Built-in Booster Heater



**NEW MODEL**



**Dry Assist**

## SPECIFIER STATEMENT

Specified unit will be Champion model UH330B undercounter high temperature dishwashing machine with built-in booster heater.

Features selectable 120, 170 and 247 second cycle times, 3 time cycle options, LED temp display, Rinse Sentry, rinse aid and detergent pumps, flexible fill and drain hoses, stainless steel top and side panels. Constructed of stainless steel.

1 year parts and labor warranty.

## OPTIONS & ACCESSORIES

- 1-RDT Dish Table** Durable, heavy-gauge stainless steel dish table with sink, stand-pipe drain, removable scrap screen holder, drain-board, backplash and lower storage cabinet. Sprayhose is optional. See 1-RDT catalog sheet) Specify right hand or left hand sink.
- Additional Dish Racks**
- 17" Stand**  
Stainless Steel
- 6" Leg Stand**
- 3 Phase Connection (prewired at factory)**
- 1" Roller Kit (includes 4 casters)**

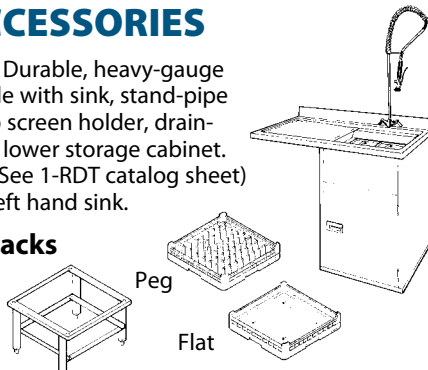

Champion Industries, Inc.  
 3765 Champion Blvd, Winston-Salem, NC 27105  
 Tel: 336/661-1556 Fax: 336/661-1979

[www.championindustries.com](http://www.championindustries.com)



# UH330B

Undercounter High Temperature  
Dishwashing Machine  
with Built-in Booster Heater

**Champion**<sup>®</sup>  
The Dishwashing Machine Specialists

Volume crated: **15 cu. ft./0.42 cu.m.**  
Shipping weight crated: **215 lbs./97.5 kg.**

Dimensions shown in inches and [millimeters]

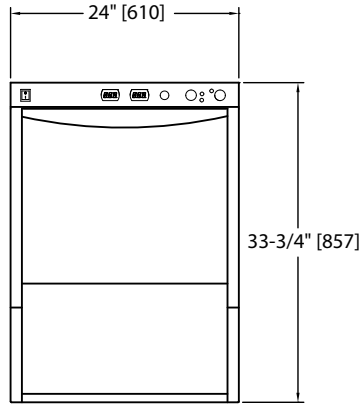

**Front View**

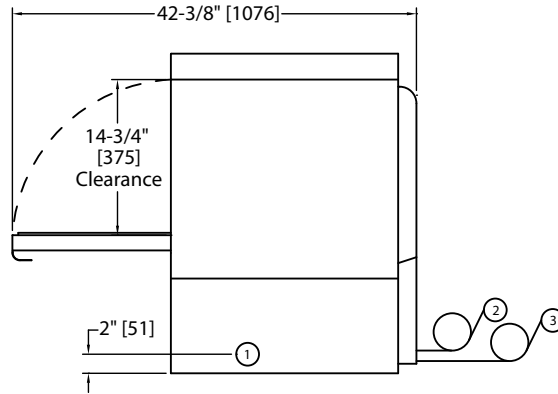

**Side View**

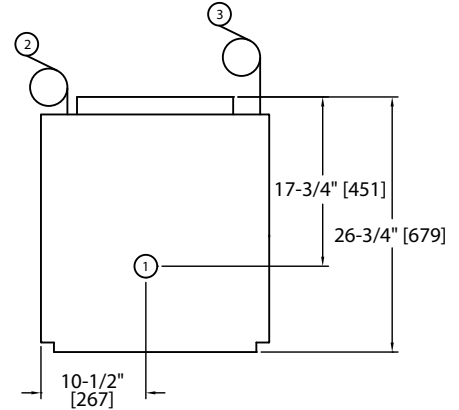

**Plan View**

## Utilities

<b>1</b>	<b>Electrical</b> 208-240/60/1; 3 wire plus ground, (See Box). 208-240/60/3; 4 wire plus ground, (See Box). Field convertible to accept 3 phase power, see service manual for details
<b>2</b>	<b>Cold Water</b> 1/2" supply; 55-80°F [12-26°C] cold water; 25 PSI min. Machine equipped with 3/4" [19] hose connector.
<b>3</b>	<b>Pumped Drain</b> 5/8" [15.9] I.D. flexible reinforced hose, 6 ft. [1829] long. Max. drain flow 15 US gpm. [12.5 imp gal] Max. drain height 3 ft. [914]

## UH330B with Booster

Elec. Specs.	Rated Amps	Minimum Supply Ckt. Conductor Ampacity	Maximum Overcurrent Protective Device
208/60/1	24	30	30
240/60/1	26	30	30
208/60/3	17	25	25
240/60/3	18	25	25

Field convertible to accept 3 phase power

**Warning** Plumbing and electrical connections should be made by qualified personnel who will observe all the applicable plumbing, sanitary and safety codes and the National Electrical Code.

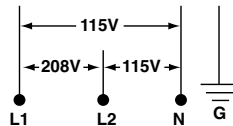

**Note:** Electrical supply service must be a 3-wire plus ground for connection shown.

## SPECIFICATIONS

### Capacities

Cycle time (seconds)	120/170/247
Racks per hr.	30/21/15

### Motor horsepower

Wash	1
------	---

### Water consumption

U.S. Gal. (Max. use) per hr.	18.2
U.S. Gal. per rack	0.76

### Temperatures °F/°C

Wash	150/66
Rinse	180/82

### Heating

Tank heat, electric, kW	2.0
Electric booster, kW	3.5

### Time Cycle in Seconds

Wash	45/95/142
Rinse	20
Heat recovery/condense	55

### Standard 20" x 20" [508 x 508]

#### Rack Complement

Dish	1
Open	1

Due to an ongoing value analysis program at Champion, specification contained in this catalog are subject to change without notice.

Champion Industries, Inc., 3765 Champion Blvd, Winston-Salem, NC 27105 • 336/661-1556 • Fax: 336/661-1979 • www.championindustries.com