



Features

Eco-Friendly Refrigerant

R290 refrigerant with a global warming potential (GWP) of 3

Cabinet Capacity

Internal area of 4.84ft³ with one (1) heavy-gauge wire shelf — adjustable in 1/2" increments using stainless steel pilasters

Easy to Clean

Aluminum interior with coved corners and finished edges, removable shelf, plus a top compartment crumb tray

Magnetic 'Thermo Rubber' Gaskets

Heavy-duty, stainless steel doors with magnetic Thermo Rubber gaskets ensure an airtight cabinet

Heavy-Duty Soft Casters

Secured to a 12-gauge steel base to ensure years of worry-free operation

Elevated Refrigerated Rail

Raise key ingredients closer to the crew for easy access — holds up to five (5) 3-1/2 quart food jars

High-Efficiency Refrigeration System

Forced air circulation provides a uniform temperature throughout the cabinet

Refrigerated Countertop Compartment

Keep key ingredients always within reach — holds up to two (2) 1/6 size and three (3) 1/9 size stainless steel pans with covers, ladels, and pan adapters included

High-Strength Doors

Heavy-duty, stainless steel doors assembled using high-load brackets for long-lasting durability

Stainless Steel Exterior

Galvanized back and bottom reduces the risk of corrosion

High-Density Insulation

Foamed-in-place, CFC-free polyurethane insulation for maximum strength, rigidity, and insulation

Drip Pan

Removable 6" drip pan provides an easy-to-clean, durable work surface

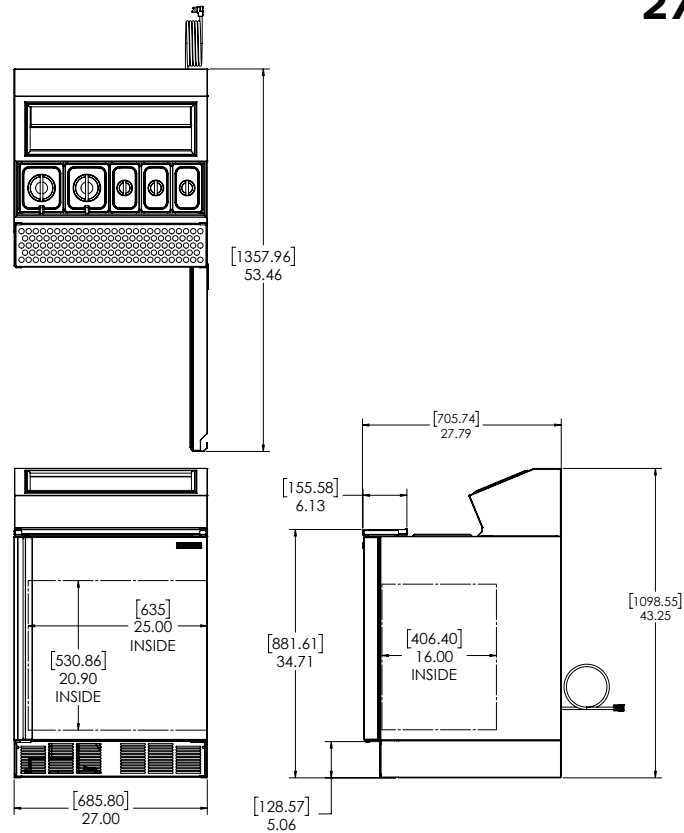

Technical Specifications

Electrical Requirements	115v/60hz/1ph/2.25A/NEMA 5-15P Plug
Product Dimensions	27"W x 43.25"H x 31.23"D (68.58cm x 109.86cm x 79.32cm)
Product Weight	190lbs (86.18kg)
Shipping Dimensions	32"W x 51"H x 37"D (81.28cm x 129.54cm x 93.98cm)
Shipping Weight	205lbs (92.99kg)
Shipping Cubic Dimensions	34.94ft ³ (.99m ³)
Temperature Range	36 to 40 (2.2 to 4.4°C)
Refrigerant	R290
Insulation	Foamed-in-place, CFC-free polyurethane

Exterior Construction	Stainless steel exterior with galvanized back and bottom
Interior Construction	Aluminum interior with coved corners and finished edges
Doors	One (1) right-hand swing door
Pan Well Capacity	Two (2) 1/6 size and three (3) 1/9 size stainless steel pans, adapters included
Rail Capacity	Five (5) 3-1/2 quart food jars
Internal Capacity	4.84ft ³
Rail Temperature	45 to 55°F
Door Gasket	Santoprene™
Shelves	Two (2) heavy-gauge wire shelves, removeable
Certifications	ETL Safety, ETL Sanitation
Warranty	1-year parts and labor, 5-year compressor (part only)

Model Number	Description
SKRNB27-ESUS2	Fountainette, 27", 115v/60hz/1ph, single right-hand swing door, NEMA 5-15P

To learn more about **Refrigerator**, visit silverking.com